

# Split Rock Resort's 28th Annual Great Tastes of Pennsylvania Wine & Food Festival

Dear Winery

Split Rock Resort is excited for our **28th Annual Great Tastes of Pennsylvania Wine and Food Festival on Saturday & Sunday, June 23rd and 24th, 2018**. We look forward to our vendors once again helping to make this a successful event. The festival will feature tastings from Pennsylvania's finest wineries, musical entertainment, crafts, food, and games during this two day outdoor event.

You will have the opportunity to sell your wine to the estimated 10,000 attendees during this time. We will have a complimentary wine pick up to further encourage the purchase of your wine. Your winery will be included in our brochure and in Split Rock Resort's advertising prior to the event.

Our application deadline is April 1, 2018. Please send the completed forms, a copy of your Certificate of Insurance, and your \$500 application fee to the address below by April 15, 2017. Applications sent in prior to March 1, 2018 will only need to pay a \$400 application fee as a thank you for early submittals. Please mail your application to:

Attn: Miriam Ray  
Split Rock Resort  
428 Moseywood Road  
Lake Harmony, PA 18624

Accommodations at Split Rock Resort are available at special rate of \$99-\$169 plus resort fee, taxes, and service charge. To reserve your room please call our in-house reservations team at 1-800-255-7625. Space is limited, and rooms will be released to the public on Monday, April 30, 2018.

We look forward to partnering with your winery this summer to continue the promotion of great tasting Pennsylvanian wines!

Sincerely,

**Miriam Ray**

[mray@splitrockresort.com](mailto:mray@splitrockresort.com)

Phone: 570-215-6106

Fax: 570-722-2999

# SITTE MAP

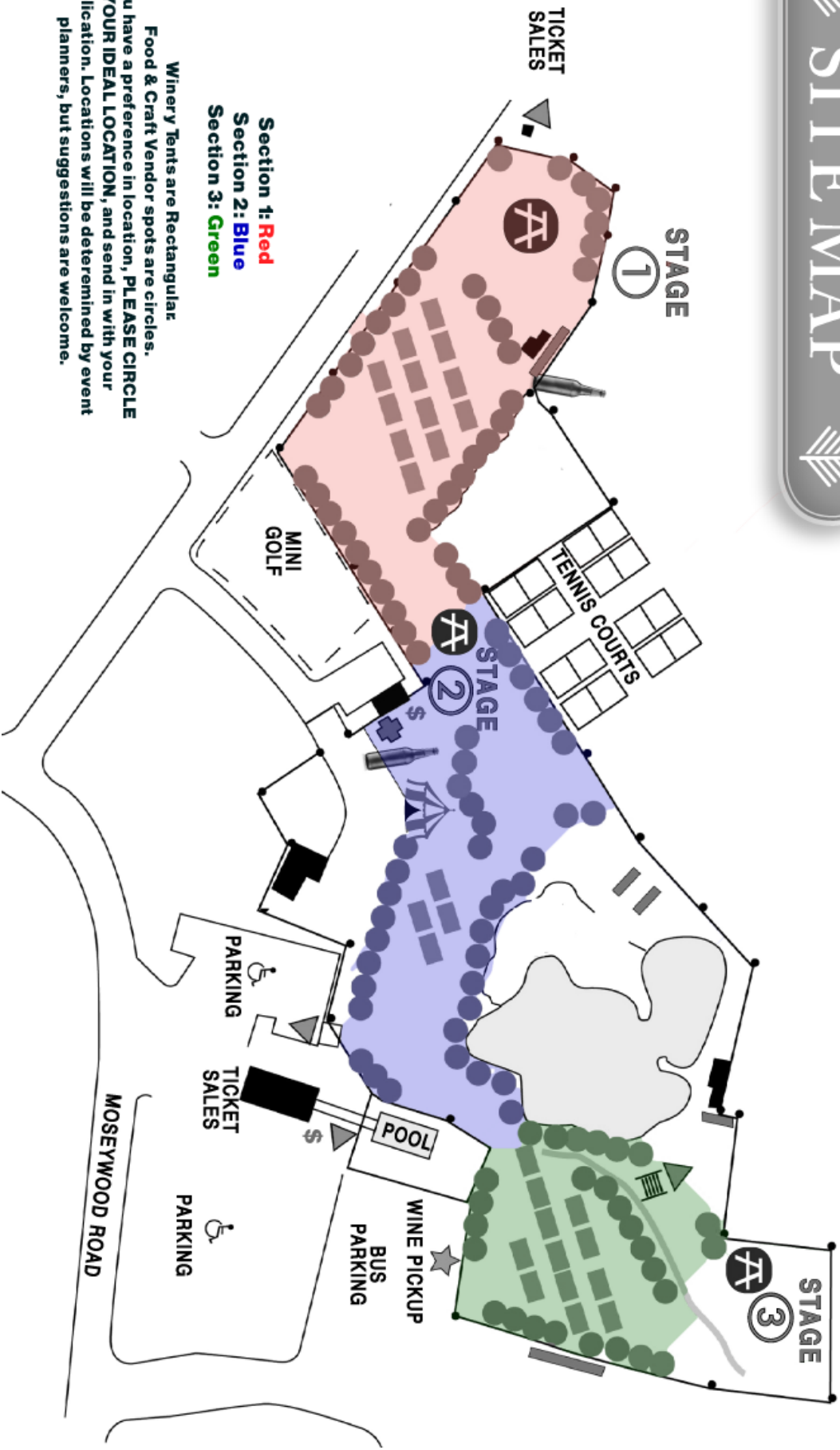

- Section 1: Red
- Section 2: Blue
- Section 3: Green

Winery Tents are Rectangular.  
 Food & Craft Vendor spots are circles.  
 If you have a preference in location, PLEASE CIRCLE  
 YOUR IDEAL LOCATION, and send in with your  
 application. Locations will be determined by event  
 planners, but suggestions are welcome.

# Split Rock Resort's 28th Annual Great Tastes of Pennsylvania Wine & Food Festival

## Wine Vendor Application

Name of Company: \_\_\_\_\_  
Contact Person: \_\_\_\_\_  
Address: \_\_\_\_\_  
City: \_\_\_\_\_ State: \_\_\_\_\_ Zip code: \_\_\_\_\_  
Phone: \_\_\_\_\_ Email: \_\_\_\_\_  
Website: \_\_\_\_\_

## **Tents**

Each winery will be assigned a 20'x20x area. A tent will be set up for your area to provide a covered space for customers and consumers to taste and buy wines. You can circle your preference of location on the previous map. While suggestions are welcome, locations will be determined at the discretion of the event planners.

## **Tables and Chairs**

We will supply tables and chairs for an additional cost. Tables are \$10 each and chairs are \$5 each. Please indicate below how many you will need.

\_\_\_\_\_ Tables                      \_\_\_\_\_ Chairs

## **Electric**

Wineries in section 1 and section 3 may purchase electric. Wineries in section 2 cannot. Please ensure that your volts are correct. Voltage will be checked during the festival, and additional fees will be assessed if you exceed your ordered AMPs.

110 volts/500 watts \$40	220 volts/20amps \$140
110 volts/1000 watts \$60	220 volts/20 amps \$180
110 volts/15 amps \$100	220 volts/30 amps \$200

Volts and Amps Requested: \_\_\_\_\_  
Generators are not permitted.

## **Ice**

Ice will be sold at the day of the event. Please estimate the amount of ice you will need.

\_\_\_\_\_ 20lb Bags    \_\_\_\_\_ 40lb Bags    \_\_\_\_\_ No Ice

To reserve rooms please call our in-house reservations team at 1-800-255-7625.

# **Split Rock Resort's 28th Annual Great Tastes of Pennsylvania Wine & Food Festival**

## **Wine Check Information**

A wine check ticket will have three parts:

- Give one copy to the customer
- Tape one copy to the top of the wine filled box
- Keep one copy for your winery

Wine Check Tips:

- Winery name needs to appear on all three wine check stickers
- Stickers must be on top of the box
- Use boxes that have an original design
- Boxes with less than 3 bottles will not be taken
- Secure box with packing tape
- Bags and gift items cannot be taken to the wine check
- Please bring a container for the wine check to put your copy of the ticket on it
- Please make sure that your wine check area is set up where it was marked when you arrived. This helps us in ensuring the efficiency of our wine check.
- Please place a pallet where your wine check pick up area is located so the bottom of the cases do not get wet or break apart.

## **Departure**

- Please do not depart before 6:30PM on Sunday June 24, 2018. This is important for the safety of our guests.
- Please clean your area before departing. There will be a \$150 fee for sites left in an unacceptable condition.